



### UNCW's Camp Lejeune Extension Office

The Camp Lejeune Extension Office is located in the John A. Lejeune Education Center, Building 825, Room 123. The John A. Lejeune Education Center is located on Stone Street, next to the Camp Lejeune DoD School Superintendent's office.

### Directions to the John A. Lejeune Education Center from the South

- Follow Hwy. 17 North to Jacksonville, NC. After passing MCAS New River's front gate, take the newly constructed by-pass toward Morehead City/Swansboro and Camp Lejeune Main Gate (to Hwy 24 East).
- Continue on Hwy 24 East and exit toward Camp Lejeune's Main Gate. Stay in the right-hand lane and stop at the *Visitor's Center* at the Front Gate (the Visitor's Center is on the right as you approach the gate).
- After you receive your temporary Visitor's pass from the Visitor's Center, enter the Front gate and continue straight on Holcomb Blvd. until you reach the first stop light.
- At the first light, turn right onto Brewster Blvd. Continue to the first stop light and turn left onto Stone Street. The John A. Lejeune Building (Bldg 825) is on your right after you pass Lejeune High School and the Stone Street Youth Pavilion.

### Parking

Parking is available in the parking lots adjacent to the Education Center. Instructors and students are allowed to park in the designated parking lots. They are advised not to park on the curb, on the grass, reserved spaces in front of the building, or in the Superintendent's parking lot.

### Parking Passes and Base Access

1. Once you enter the Camp Lejeune Main Gate, you will need to check in at the Visitor's Office at the Front Gate. When you report there, please provide them with:
  - a valid driver's license
  - proof of auto insurance
  - vehicle registration
  - detailed UNCW current semester class schedule
  - UNCW Student ID (recommended)
2. After you stop at the main gate, come to the John A. Lejeune Education Center, Building 825, Room 123 to receive a *Camp Lejeune Request for a Base Pass Form*, if you don't have one. The *Base Pass Form* will be distributed to students participating in on base classes during their first scheduled class. **The Base Pass Office will not issue passes prior to the first day of the semester.**

*\* Please Note: Any vehicle not registered to the driver requires additional documentation. The driver of the vehicle must have a letter signed and notarized in order to receive a base parking pass. Call the Vehicle Pass Office at 910-451-1793 for details. A sample letter is posted on the extension website under the "for students" section at [www.uncw.edu/extension](http://www.uncw.edu/extension).*
3. Take completed *Camp Lejeune Request for a Base Pass Form*, to the Vehicle Pass Office, which is Building 60, Room 161. The Vehicle Registration's office phone number is (910) 451-1793.
  - *Directions to the Vehicle Pass Office:* From Building 825, take a right onto Stone Street, take Stone Street to the stop light. Make a left onto McHugh Blvd and take a left onto Virginia Dare Road/Molly Pitcher Road. Building 60 is on your right next to Andy's Restaurant.

### Important Reminders When Driving On Base

- **Cell Phones:** You may not use your cell phone on base while driving unless you have a hands-free system. Violation of this law will result in a ticket, court date, and possible removal of base driving privileges.
- **Speed Limit:** Failure to drive the speed limit on base may result in a ticket, visit to traffic court and possible removal of base driving privileges.

# MCCS FACILITIES, CAMP LEJEUNE, NC

To Onslow Beach  
To Courthouse Bay, Courthouse Bay Recreation Center Bldg. BB-27 & Sneads Ferry Gate

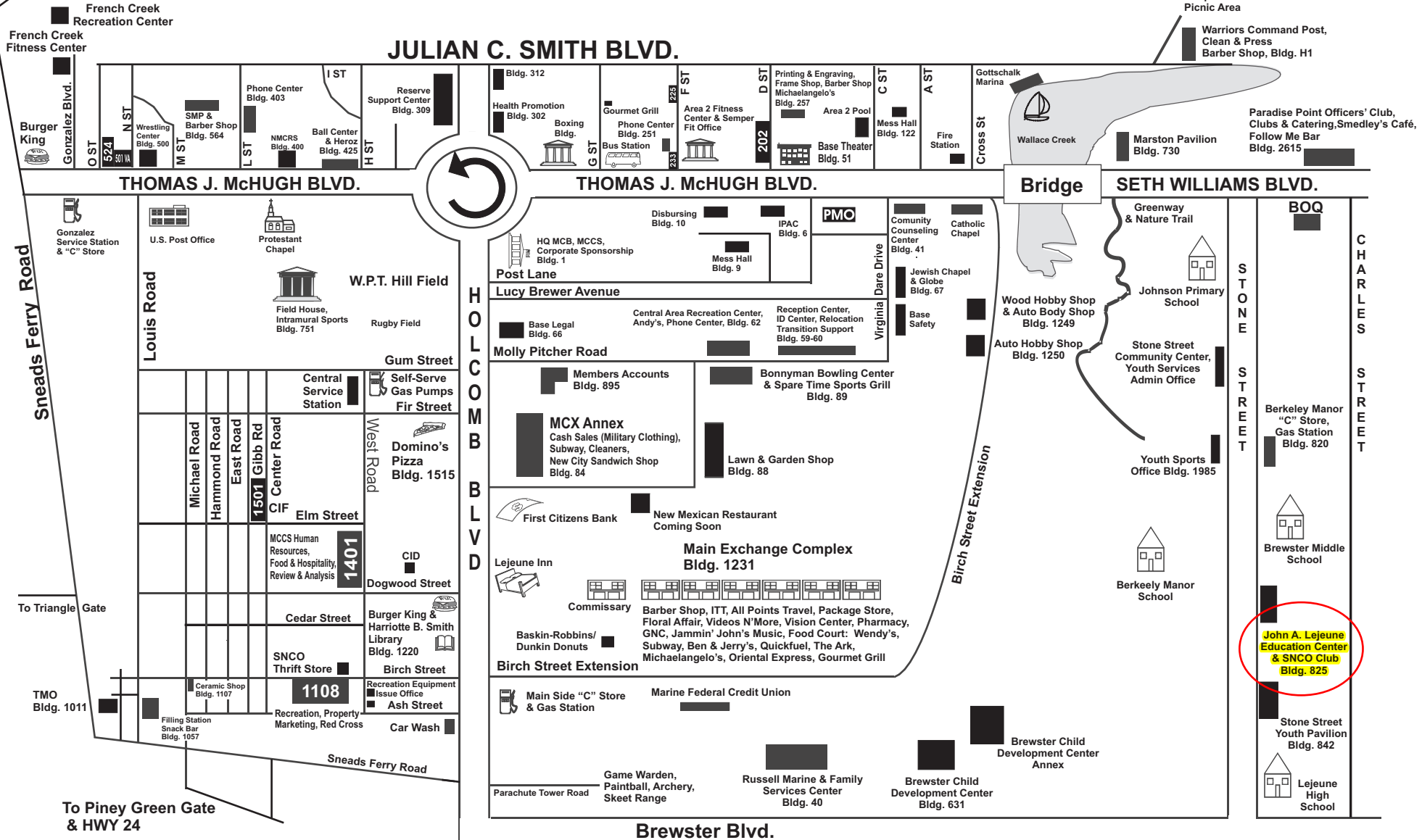

## Important Web Sites:

Lejeune Links: [www.lejeune.usmc.mil](http://www.lejeune.usmc.mil)  
 MCCS Links: [www.mccslejeune.com](http://www.mccslejeune.com)  
 Military One Source: [www.militaryonesource.com](http://www.militaryonesource.com)  
[www.Militaryhomefront.dod.mil](http://www.Militaryhomefront.dod.mil)

**MAIN GATE**  
Hwy. 24

**THIS MAP IS NOT TO SCALE.**

**Updated May 2008**

**HOSPITAL**

Paradise Point  
Golf Course

Brewster Recreation  
Area

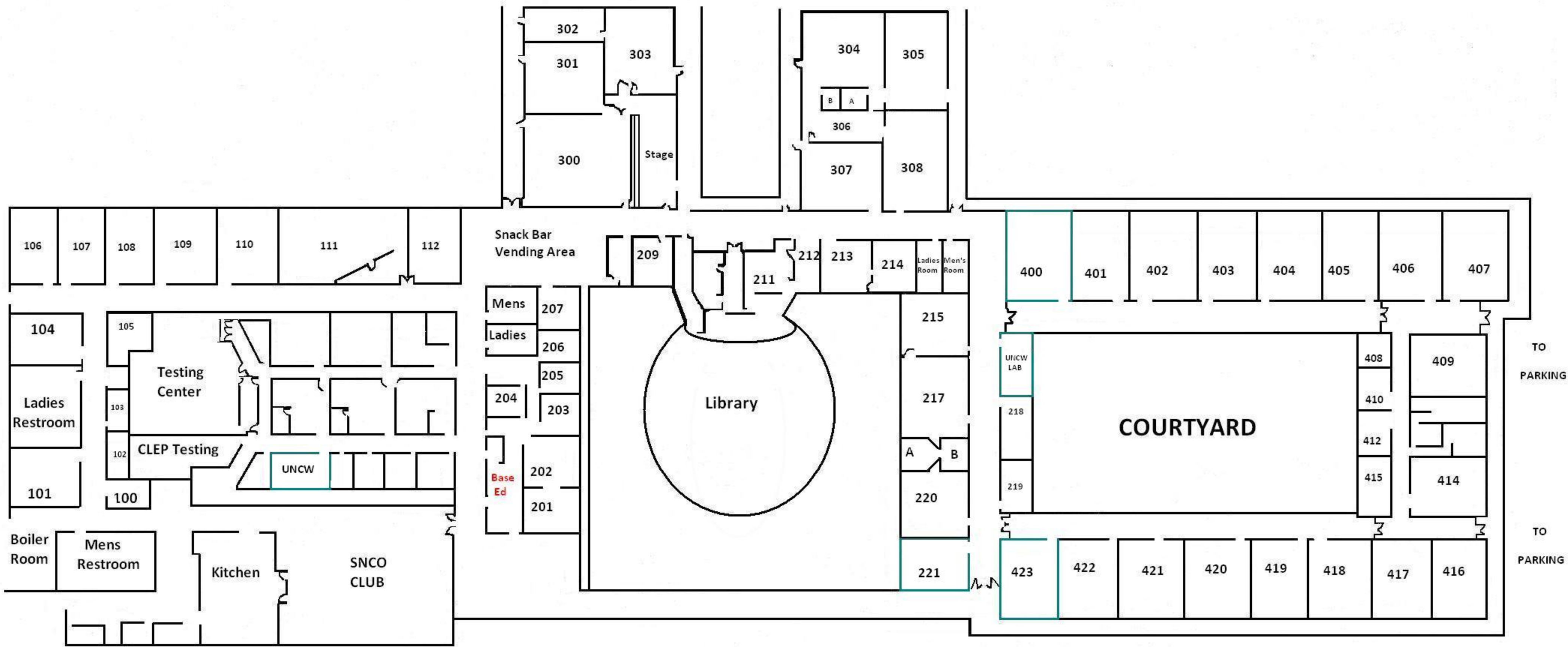

**JOHN A. LEJEUNE EDUCATION CENTER  
BUILDING 825**